

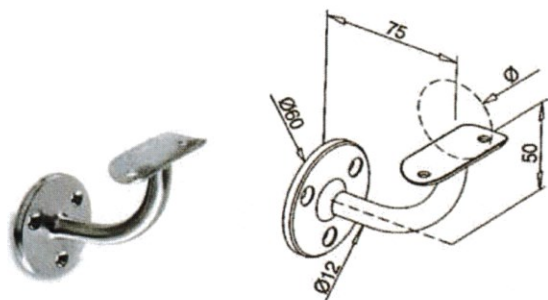

SUPPORTI PER CORRIMANO A MURO

6

6 Supporti corrimano a muro



Sostegno a muro fisso

Art. Nr.	Ø	Base	Materiale
040D33	33,7	Ø60	Aisi 304
040D42	42,4	Ø60	Aisi 304

KIT inox completo di:

040D33KX viti 738005x10 e ancoranti UX85

040D42KX viti 738005x10 e ancoranti UX85

KIT legno completo di:

040D33KW viti 798105x25 e ancoranti UX85

040D42KW viti 798105x25 e ancoranti UX85

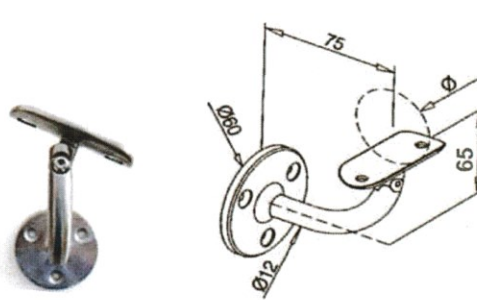

Sostegno a muro con snodo

Art. nr.	Ø	Base	Materiale
041D33	33,7	Ø60	Aisi 304
041D42	42,4	Ø60	Aisi 304

KIT inox completo di

041D33KX viti 738005x10 e ancoranti UX85

041D42KX viti 738005x10 e ancoranti UX85

KIT legno completo di

041D33KW viti 798105x25 e ancoranti UX85

041D42KW viti 798105x25 e ancoranti UX85

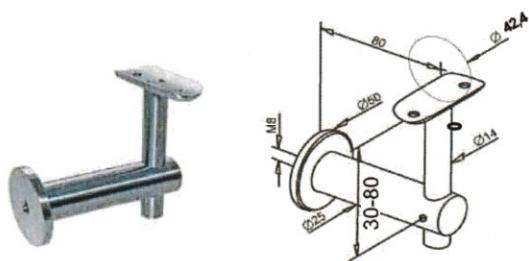

Supporto a muro fisso per corrimano *new*

Art. Nr.	Ø	Materiale
247	42,4	Aisi 304

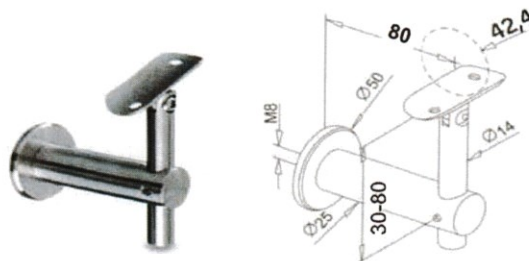

Supporto a muro con snodo per corrimano

Art. nr.	Ø	Materiale
246	42,4	Aisi 304

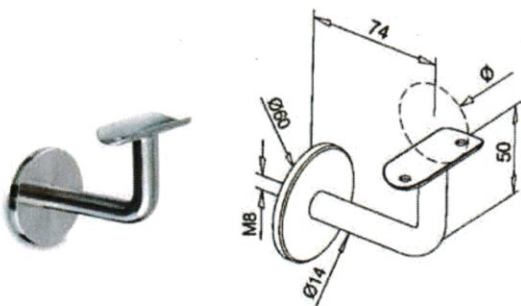

Supporto pieno fisso a muro

Art. Nr.	Ø	Base	Materiale
043D33	Ø33,7	Ø60	Aisi 304
043D42	Ø42,4	Ø60	Aisi 304

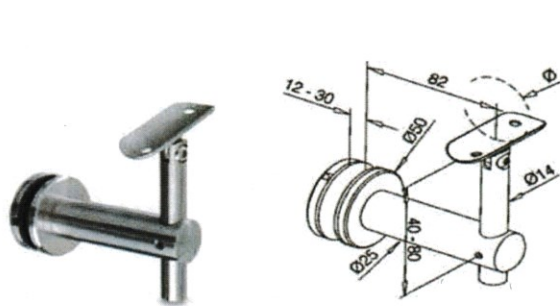

Supporto a vetro con snodo per corrimano

Art. nr.	Ø	Materiale
249	42,4	Aisi 304

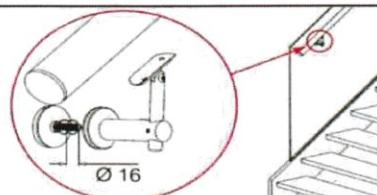
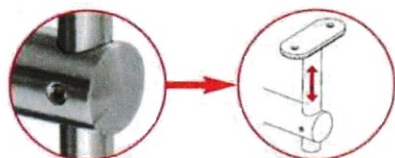
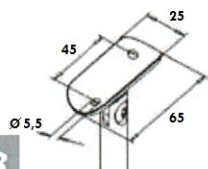

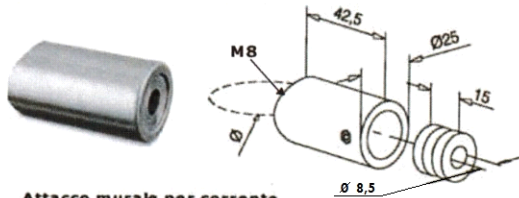

Attacco murale per corrente

Art. Nr.	Ø	Materiale
025F	Piatto	Aisi 304
025D33	Ø33,7	Aisi 304
025D42	Ø42,4	Aisi 304
025D48	Ø48,3	Aisi 304

new

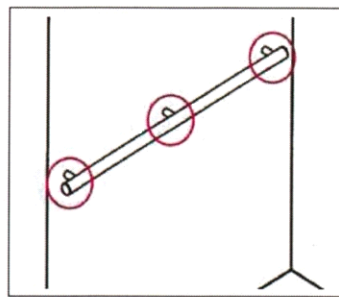

- 1 Fissare al muro il cilindro interno
- 2 Fissare al tubo la parte esterna
- 3 Posizionare il corrimano

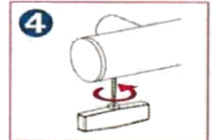
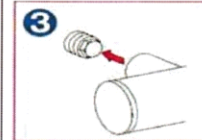
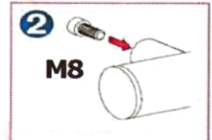

- 2 Fissare al tubo la parte esterna
- 4 Stringere il grano

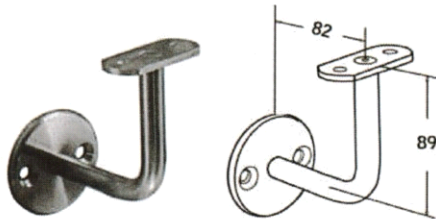

Asta curva fissa "DE"(2 fori)

Art. nr.	Ø Flangia	Piastrina	Materiale
4DE043	70	Piatta	Aisi 304
6DE043	70	Piatta	Aisi 316
4DE143	70	Ø33,7	Aisi 304
6DE143	70	Ø33,7	Aisi 316
4DE243	70	Ø42,4	Aisi 304
6DE243	70	Ø42,4	Aisi 316
4DE343	70	Ø48,3	Aisi 304
6DE343	70	Ø48,3	Aisi 316

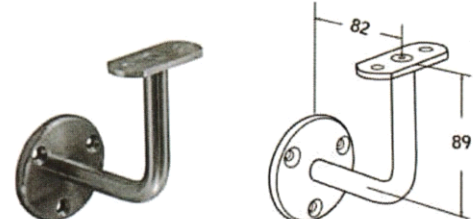

Asta curva fissa "DG"(3 fori)

Art. nr.	Ø Flangia	Piastrina	Materiale
4DG043	70	Piatta	Aisi 304
6DG043	70	Piatta	Aisi 316
4DG143	70	Ø33,7	Aisi 304
6DG143	70	Ø33,7	Aisi 316
4DG243	70	Ø42,4	Aisi 304
6DG243	70	Ø42,4	Aisi 316
4DG343	70	Ø48,3	Aisi 304
6DG343	70	Ø48,3	Aisi 316

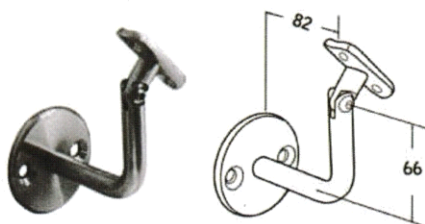

Asta curva snodata "DF"(2 fori)

Art. nr.	Ø Flangia	Piastrina	Materiale
4DF043	70	Piatta	Aisi 304
6DF043	70	Piatta	Aisi 316
4DF143	70	Ø33,7	Aisi 304
6DF143	70	Ø33,7	Aisi 316
4DF243	70	Ø42,4	Aisi 304
6DF243	70	Ø42,4	Aisi 316
4DF343	70	Ø48,3	Aisi 304
6DF343	70	Ø48,3	Aisi 316

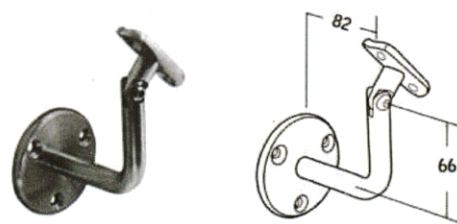

Asta curva snodata "DH"(3 fori)

Art. nr.	Ø Flangia	Piastrina	Materiale
4DH043	70	Piatta	Aisi 304
6DH043	70	Piatta	Aisi 316
4DH143	70	Ø33,7	Aisi 304
6DH143	70	Ø33,7	Aisi 316
4DH243	70	Ø42,4	Aisi 304
6DH243	70	Ø42,4	Aisi 316
4DH343	70	Ø48,3	Aisi 304
6DH343	70	Ø48,3	Aisi 316

INOX-Flex

Gamma di articoli in acciaio inossidabile per ringhiere facilmente assemblabili con viti M6/M8 per creare l'articolo che necessita.

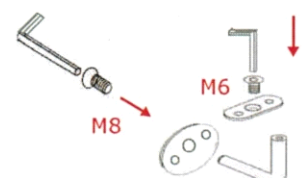

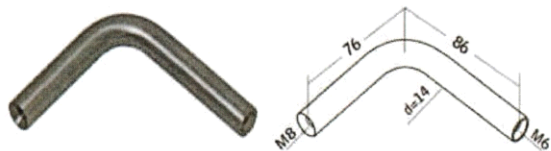

Perno curvo fisso "DE"

Art. nr.	Materiale
D4E4	Aisi 304
D6E4	Aisi 316



Perno curvo snodato "DF"

Art. nr.	Materiale
D4F4	Aisi 304
D6F4	Aisi 316

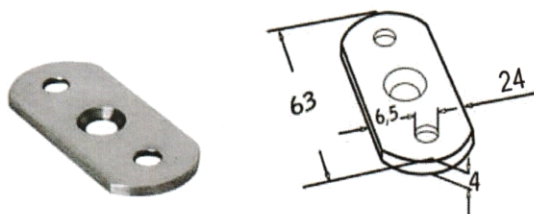

Piastrina di appoggio "Piatta"

Art. nr.	Appoggio	i	Materiale
D4A021	Piatto	43	Aisi 304
D6A021	Piatto	43	Aisi 316

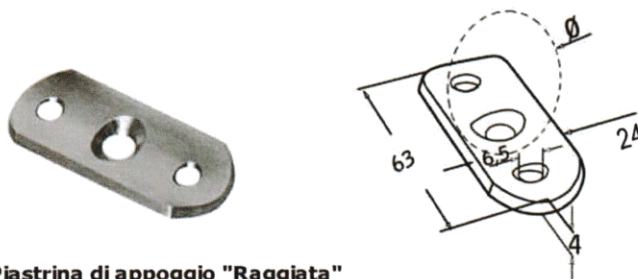

Piastrina di appoggio "Raggiata"

Art. nr.	Ø	i	Materiale
D4A121	33,7	43	Aisi 304
D6A121	33,7	43	Aisi 316
D4A221	42,4	43	Aisi 304
D6A221	42,4	43	Aisi 316
D6A322	48,3	43	Aisi 316

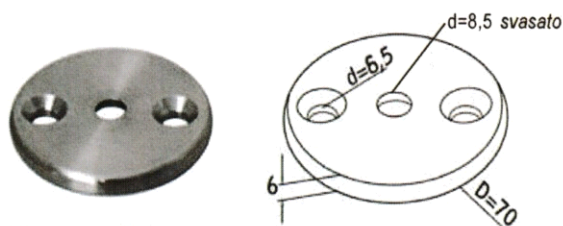

Flangia Ø70 mm

Art. Nr.	N° Fori	Materiale
D4H3	3	Aisi 304
D6H3	3	Aisi 316

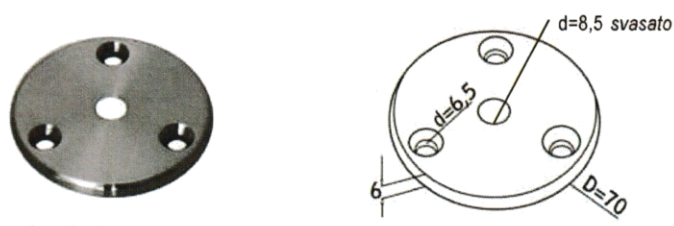

Flangia Ø70 mm

Art. Nr.	N° Fori	Materiale
D4L3	4	Aisi 304
D6L3	4	Aisi 316

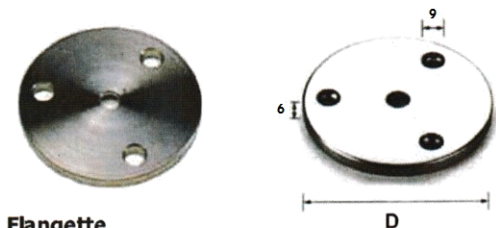

Flangette

Art. No.	D	Materiale
060	60	Aisi 304
070	80	Aisi 304

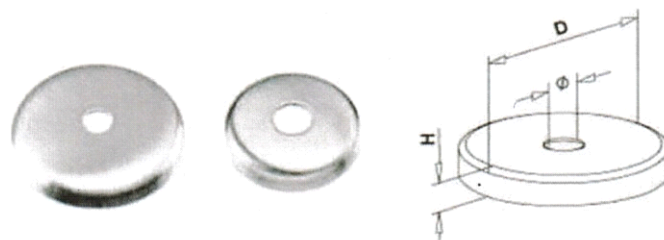

Copertura per Flangette

Art. Nr.	D	Ø	H	Utilizzo	Materiale
050	76	14,5	12	Inox Flex DM-DN-DE-DF-DG-DH	Aisi 304
065	70	12,5	13	Art. 060-041D33-041D42	Aisi 304
075	70	14,5	13	Art. 060	Aisi 304

INOX

LEGNO Ø42

- | | | |
|------------------------------------|-----------------------------------|-------------------------------------|
| <input type="checkbox"/> Ø33,7x2,0 | <input type="checkbox"/> Faggio | <input type="checkbox"/> Noce/Teak |
| <input type="checkbox"/> Ø42,4x2,0 | <input type="checkbox"/> Ciliegio | <input type="checkbox"/> Noce scuro |
| <input type="checkbox"/> Ø48,3x2,0 | <input type="checkbox"/> Rovere | <input type="checkbox"/> Larice |
| <input type="checkbox"/> 40x40x2,0 | | |

Accessorio Fissaggio a muro: **Art.** _____

Tappi / Calotte: **Art.** _____

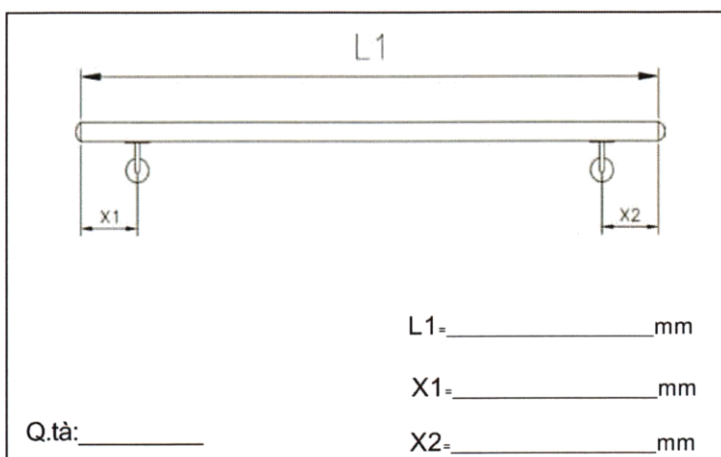

INOX

LEGNO Ø42

- | | | |
|------------------------------------|-----------------------------------|-------------------------------------|
| <input type="checkbox"/> Ø33,7x2,0 | <input type="checkbox"/> Faggio | <input type="checkbox"/> Noce/Teak |
| <input type="checkbox"/> Ø42,4x2,0 | <input type="checkbox"/> Ciliegio | <input type="checkbox"/> Noce scuro |
| <input type="checkbox"/> Ø48,3x2,0 | <input type="checkbox"/> Rovere | <input type="checkbox"/> Larice |
| <input type="checkbox"/> 40x40x2,0 | | |

Accessorio Fissaggio a muro: **Art.** _____

Tappi / Calotte: **Art.** _____

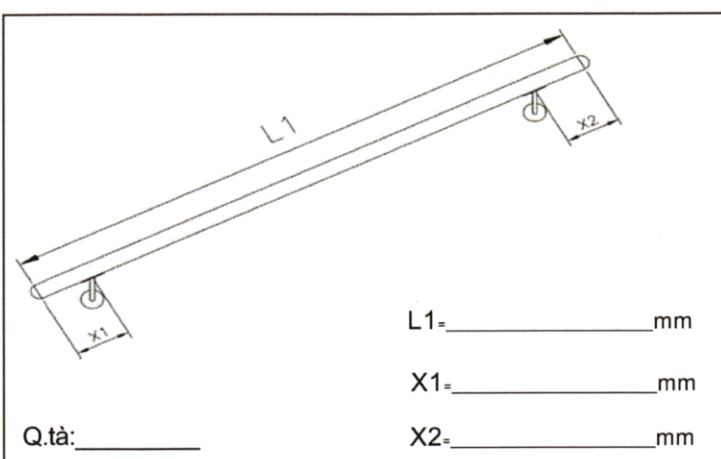

INOX

LEGNO Ø42

- | | | |
|------------------------------------|-----------------------------------|-------------------------------------|
| <input type="checkbox"/> Ø33,7x2,0 | <input type="checkbox"/> Faggio | <input type="checkbox"/> Noce/Teak |
| <input type="checkbox"/> Ø42,4x2,0 | <input type="checkbox"/> Ciliegio | <input type="checkbox"/> Noce scuro |
| <input type="checkbox"/> Ø48,3x2,0 | <input type="checkbox"/> Rovere | <input type="checkbox"/> Larice |
| <input type="checkbox"/> 40x40x2,0 | | |

Accessorio Fissaggio a muro: **Art.** _____

Tappi / Calotte: **Art.** _____

